

Front Portal Axle Units for Axial Wraith

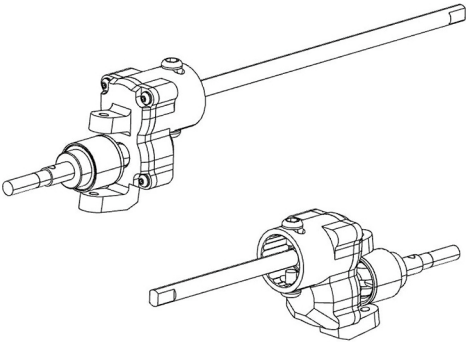

1.

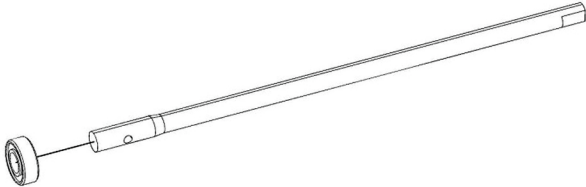

Bearing: 5x11x4mm

2.

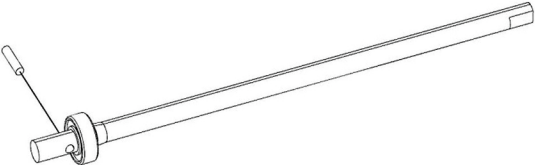

Pin: 2x8mm

3.

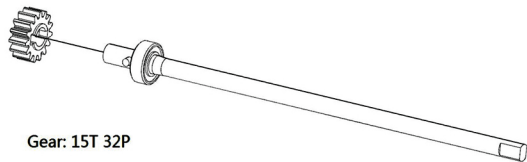

Gear: 15T 32P

4.

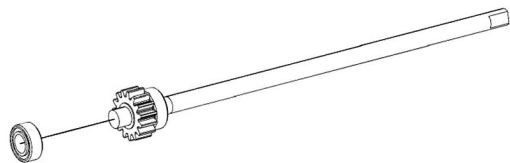

Bearing: 5x10x4mm

5.

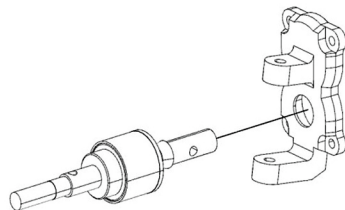

6.

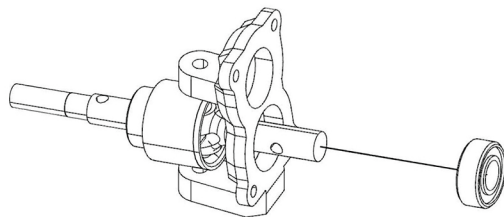

Bearing: 5x11x4mm

7.

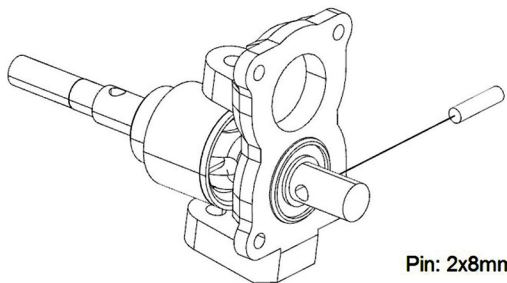

Pin: 2x8mm

9.

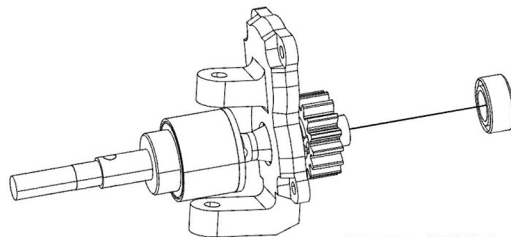

Bearing: 5x9x3mm

8.

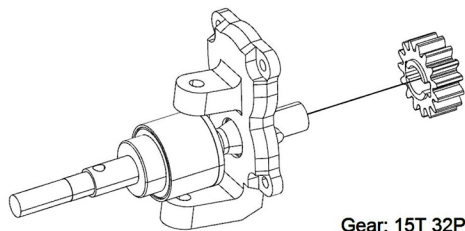

Gear: 15T 32P

10.

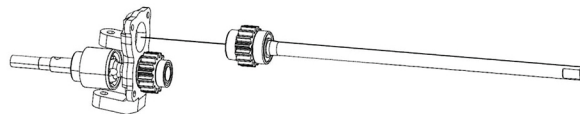

11.

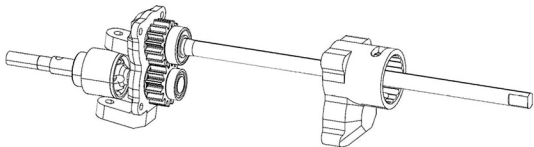

12. Suggested to use Medium grade threadlock(Not Included)

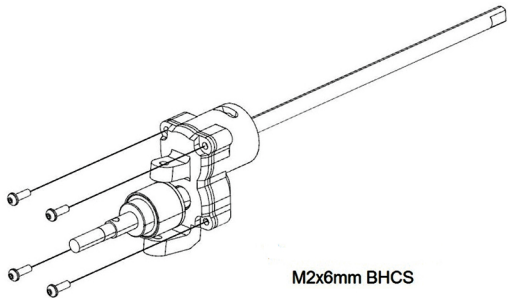

13. Stock M3x6mm Plastic Thread Screws(Not Included).

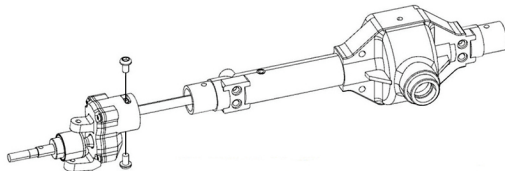

14. Stock M3x6mm Plastic Thread Screws(Not Included).

